

ENTERY INDUSTRIAL CO., LTD.
 APR - 2. 2014
 R&D D.C.C. ISSUED

- NOTES: MATERIAL & FINISH
 1.INSULATOR:HIGH-TEMP THERMOPLASTIC, UL94V-0
 COLOR:NATURAL OR BLACK
 2.CONTACT: COPPER ALLOY T=0.30 ±0.01mm
 3.PLATING: GOLD FLASH OR TIN OR MATTE-TIN
 OVERALL NICKEL UNDER PLATED.
 4.LOCKING WINDOW:ONE PLACE FOR 2 TO 7 CKT.
 TWO PLACE FOR MORE THAN 8 CKT.
 5.ORDER INFORMATION: 3800K-XXXX-03,33 X

PACKING:E: TUBE
 R: PLASTIC REEL
 L: PAPER REEL
 D: VACUUM AND HUMIDIYT LABEL
 TYPE 03: PA46
 03: LCP (HALOGEN FREE)
 33: LCP (BLACK) (HALOGEN FREE)

N: STANDARD
 Y: PRINTING DATE
 PIN NO.

PLATED:
 E: TIN
 F: GOLD FLASH
 Q: MATTE-TIN

3800K: 1.25 WIRE TO BOARD SMT R/A TYPE SINGLE ROW
 (HALOGEN FREE)

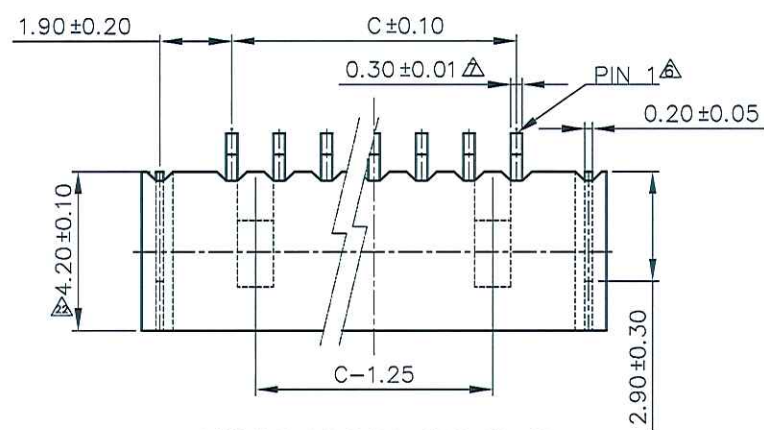

LOCKING WINDOW: TWO PLACE
 MORE THAN 8 CKT.

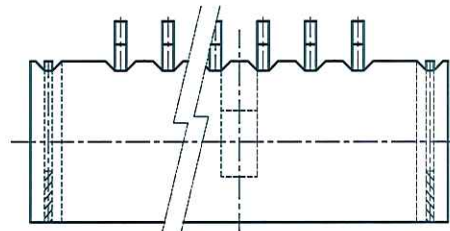

LOCKING WINDOW: ONE PLACE
 2 TO 7 CKT.

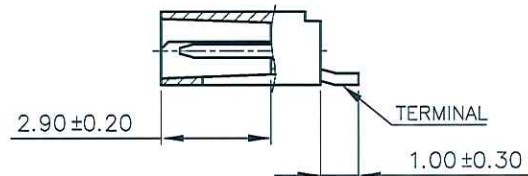
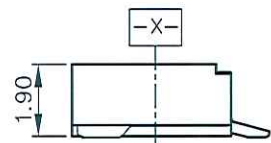
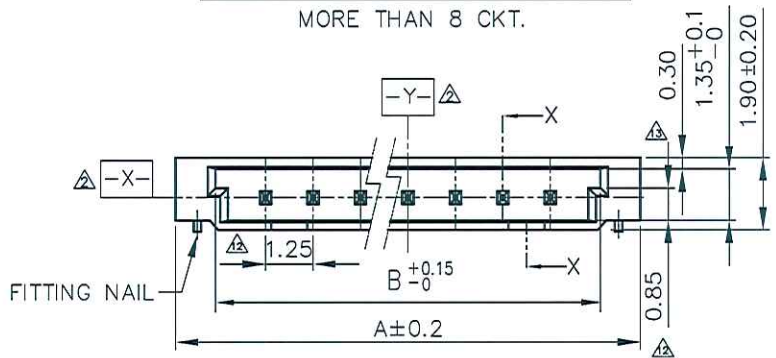

SECTION X-X

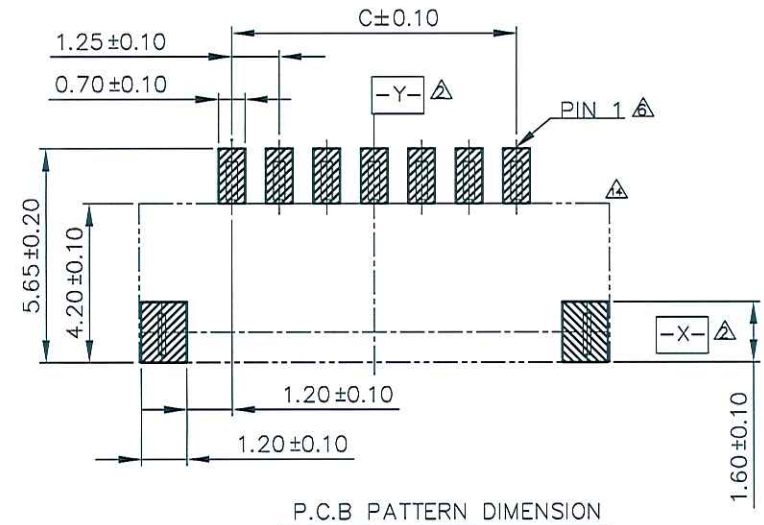
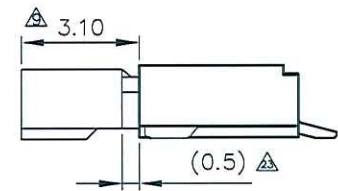
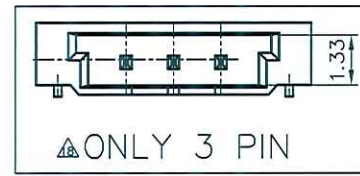

P.C.B PATTERN DIMENSION

PIN.	A	B	C
02	6.00	3.90	1.25
03	7.25	5.15	2.50
04	8.50	6.40	3.75
05	9.75	7.65	5.00
06	11.00	8.90	6.25
07	12.25	10.15	7.50
08	13.50	11.40	8.75
09	14.75	12.65	10.00
10	16.00	13.90	11.25
11	17.25	15.15	12.50
12	18.50	16.40	13.75
13	19.75	17.65	15.00
14	21.00	18.90	16.25
15	22.25	20.15	17.50
16	23.50	21.40	18.75
18	26.00	23.90	21.25
20	28.50	26.40	23.75
25	34.75	32.65	30.00
30	41.00	38.90	36.25



REN140310	Juno	03/31/14	GENERAL TOLERANCE UNLESS OTHERWISE SPECIFIED
RE201303007	Juno	04/01/13	X.X ±0.25
RE201208004	MAX	12/26/12	X.XX ±0.13
RE201209003	JIMMY	08/12/12	X.XXX ANG. ±0'30'
RE201203001	JIMMY	03/10/12	
RE201112011	JIMMY	12/26/11	
SER RENS0810	CHK	DATE	

CUSTOMER: 恩得利工業股份有限公司 ENTERY INDUSTRIAL CO., LTD.

DRAWN: Johnny NOV-28-2007

CHECKED: [Signature]

APPROVED: [Signature]

SHEET: 1/1

PART NO.: 3800K-XXXX-03,33X

TITLE: 1.25 WIRE TO BOARD SMT R/A TYPE SINGLE ROW

UNIT: MM SCALE: 5:1 SIZE: A4 REV: W