

NOTES: MATERIAL & FINISH

1.INSULATOR:HIGH-TEMP THERMOPLASTIC, UL94V-0
COLOR:BLACK

2.CONTACT:COPPER ALLOY(t=0.25)
PLATING:TIN OR TIN OR MATTE-TIN PLATED

3.FITTING NAIL:COPPER ALLOY(t=0.3)
PLATING: TIN PLATED

△4.TOLERANCE NON ACCUMULATIVE

△△5.ORDER INFORMATION: 7151K-X XX N-02X



PACKING:E:TUBE
R:PLASTIC REEL
△L:PAPER REEL

PIN PLATING: E:TIN
Q:MATTE-TIN

7151K:1.0 NON/ZIF FPC SMT R/A(HALOGEN-FREE)

PIN	A	B	C
03	6.0	2.0	4.15
04	7.0	3.0	5.15
05	8.0	4.0	6.15
06	9.0	5.0	7.15
07	10.0	6.0	8.15
08	11.0	7.0	9.15
09	12.0	8.0	10.15
10	13.0	9.0	11.15
11	14.0	10.0	12.15
12	15.0	11.0	13.15
13	16.0	12.0	14.15
14	17.0	13.0	15.15
15	18.0	14.0	16.15
16	19.0	15.0	17.15
17	20.0	16.0	18.15
18	21.0	17.0	19.15
19	22.0	18.0	20.15
20	23.0	19.0	21.15
21	24.0	20.0	22.15
22	25.0	21.0	23.15
23	26.0	22.0	24.15
24	27.0	23.0	25.15
25	28.0	24.0	26.15
26	29.0	25.0	27.15
27	30.0	26.0	28.15
28	31.0	27.0	29.15
29	32.0	28.0	30.15
30	33.0	29.0	31.15

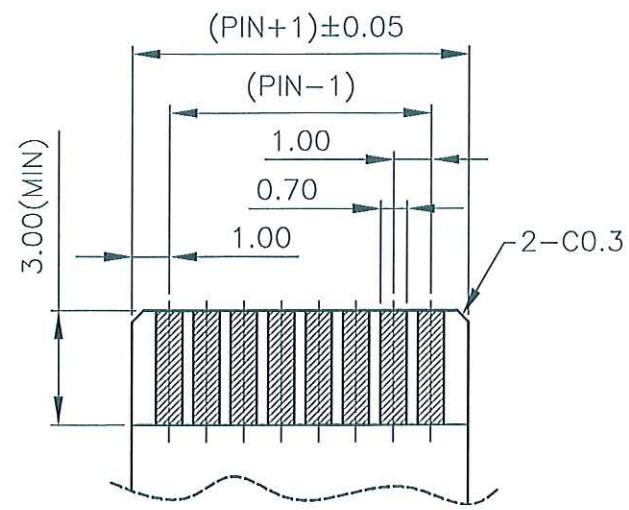
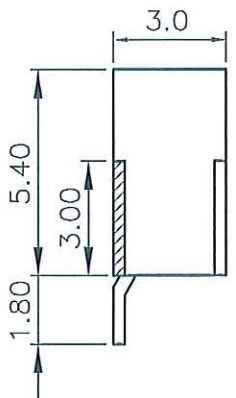
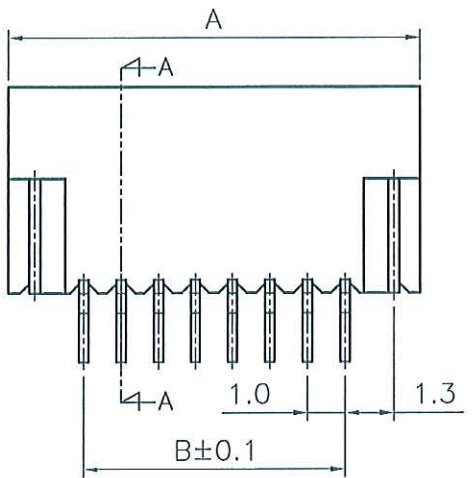
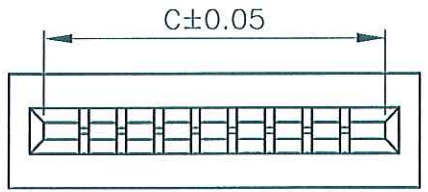

RECOMMENDED APPLICABLE
FPC LAYOUT (THICKNESS: 0.3 ± 0.03)

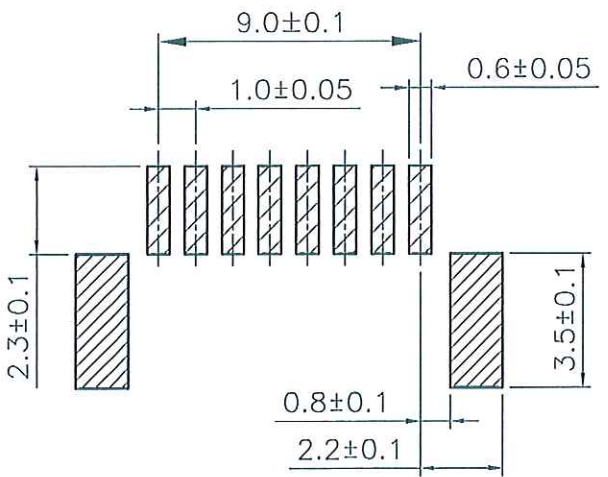

RECOMMENDED PATTERN DIM. (REF.)

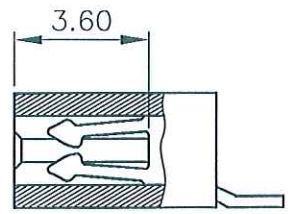

SECTION A-A

ENTERY INDUSTRIAL CO., LTD.
JAN 10. 2013
R&D D.C.C. ISSUED

SER	REVISIONS	CHK	DATE
△	RE201206014	JIMMY	12/21/12
△	RE201210002	JIMMY	07/29/11
△	REN110720	JOAN	07/11/08
△	RE080611	JOAN	11/02/07
△	REN71102	JOAN	03/21/07

GENERAL TOLERANCE UNLESS OTHERWISE SPECIFIED
X.X ±0.30
X.XX ±0.20
X.XXX
ANG. ±0°30'

CUSTOMER
DRAWN ALICE JAN-15-2007
CHECKED
APPROVED
SHEET 1/1

恩得利工業股份有限公司
ENTERY INDUSTRIAL CO., LTD.

PART NO. △△
7151K-XXXN-02X
TITLE:
1.0 NON/ZIF FPC SMT R/A
UNIT MM SCALE 5:1 SIZE A4 REV F